



Existing bollards on Green Walk to be removed and replaced with new 'city' type bollards (pictured) to prevent footway parking

Existing footways to be resurfaced in asphalt to match Rothsay Street

Tactile paving pedestrian crossing points to be installed to across both arms of the junction

Existing footway to be resurfaced in asphalt to match Rothsay Street

Tree planting to be provided on new footway buildout at either end of parking bay



Existing resident / pay and display parking bay to be incorporated within footway buildout

Existing footway to be built out to improve width and resurfaced in asphalt (same material as Rothsay Street)

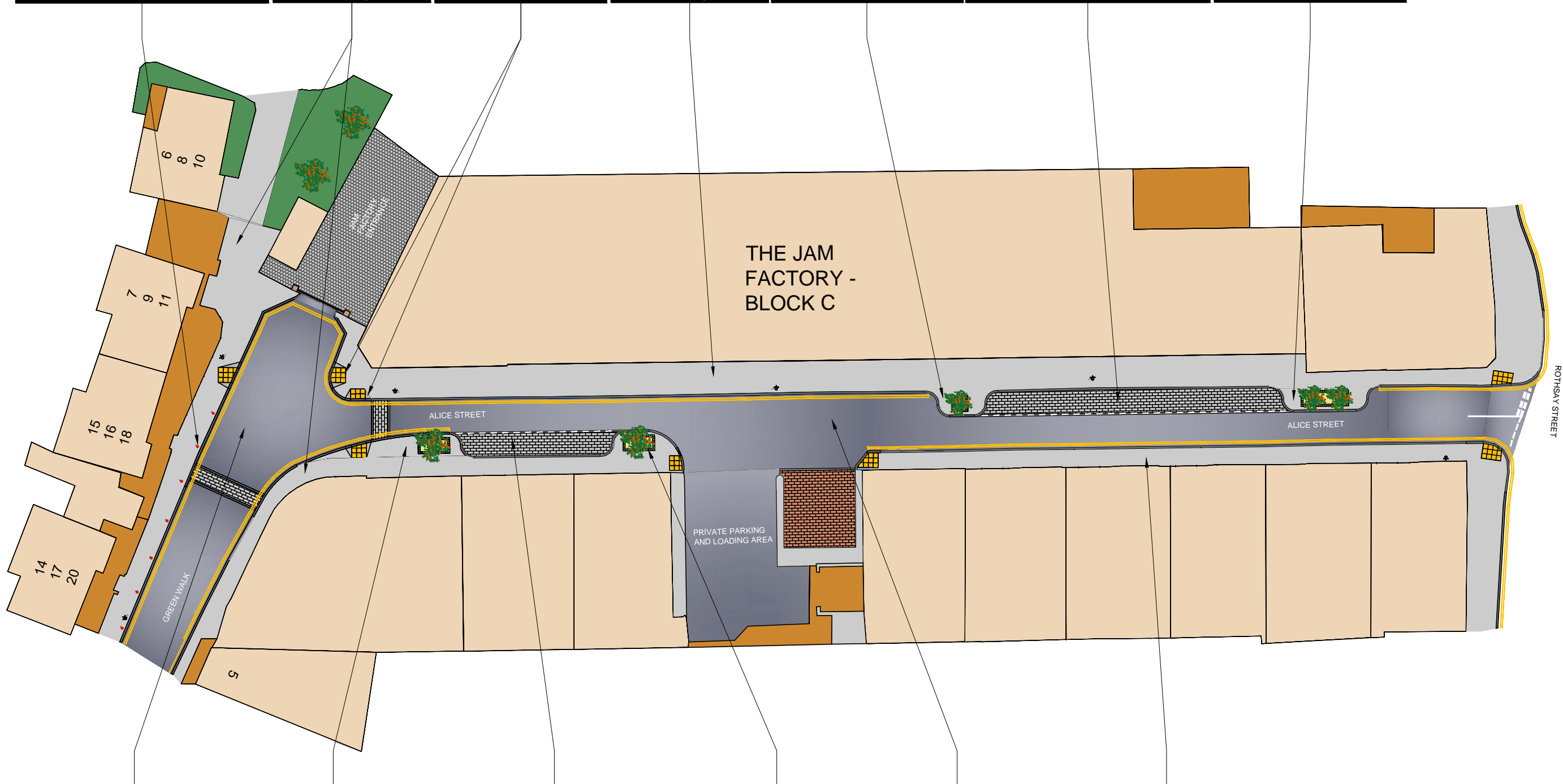

Proposed raised carriageway table to improve pedestrian accessibility at Green Walk / Alice Street junction

Existing footway to be built out to improve width and resurfaced in asphalt (same material as Rothsay Street)



New resident / pay and display parking bay to be provided (within proposed footway buildout).

Tree planting to be provided on new footway buildout at either end of parking bay

Existing carriageway to be resurfaced for entire length of Alice Street

Existing footway to reconstructed to provide an even, flat surface for pedestrians and resurfaced in asphalt